

AC-10 Actuator

Large handle - Flush mount

Features

- Rear mount installation
- Flush mounting style
- Single, multi-point or direct pull actuation capability
- Multiple key code options
- Non-locking option

Installation Notes

- Installation torque of mounting nuts not to exceed 7 N.m
- Mounting nut (M6 x 1) not supplied
- AC-10 can only use snub end coupling (type 6 or 7 cable)

Material

- Housing, handle, rotating linkage: Glass-filled reinforced nylon, black
- Threaded stud and cable bracket retainers: Steel, zinc nickel
- Housing and handle gaskets: Adhesive backed foam, black

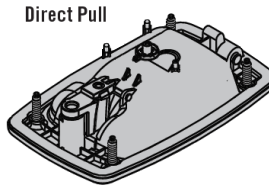
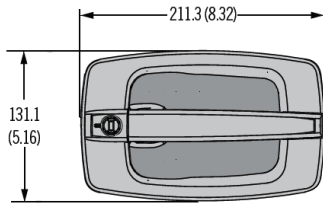
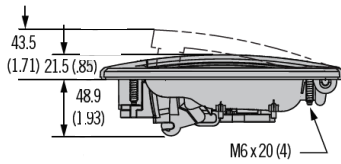

Direct Pull

- Recommended to use with Trigger Pull



Part Number	
Trigger Pull	R4-0-51292

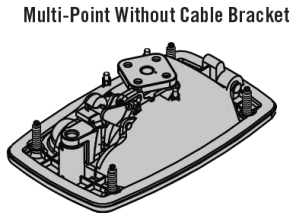

Multi-Point Without Cable Bracket

- Recommended to use with Rods

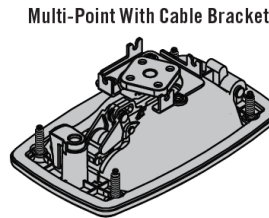

Multi-Point With Cable Bracket

- Recommended to use with Cables: see AC Cable drawing J-AC-C for cable selection.

Panel Preparation

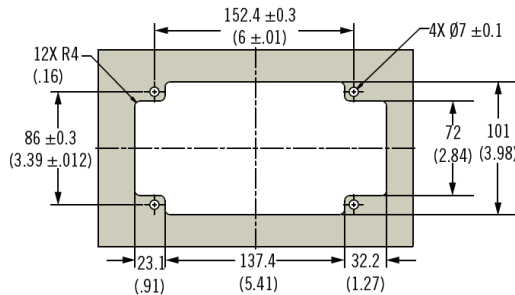

Notes

- For use with rods / cables, recommended snap-in retainer for rotator plate: R4-0-43922
- Contact Gripwell for lock core selection and detailed key information

S Actuation Style

- 1 Single Point, Direct Pull
- 2 Multi-Point, without Cable Bracket
- 3 Multi-Point, with Cable Bracket

L Locking Options

- 0 Non-Locking
- 1 Reversible key (No keys - R001)
- 2 Reversible key (2 keys included - R001)
- 3 Reversible key (keyed differently - 2 keys included)
- 4 Standard key (No keys - CH751)
- 5 Standard key (2 keys included - CH751)
- 6 Standard key (keyed differently - 2 keys included)
- 9 No Lock Plug installed (See notes for more information)

KC Key Codes

- (Omit for Locking Options 0, 1, 2, 4, 5 and 9)
 *KD10 Keyed Differently (Only used if L = 3 or 6)
 *MK10 Master Keyed Differently (Only used if L = 6)

*Supplied in multiples of 10 with 10 different key codes.

AC - 10 - S L 1 - 11 - KC